

ACT Grid Ceilings (G1)

System Overview

+ G1 – Non-Power Mounting Kit

- 1 x Main T-Bar Clip
- 1 x Secondary T-Bar Clip
- 1 x Non-Power Canopy
- 1 x ¼-20 Griplock Coupler
- 1 x A/C Suspension Cable

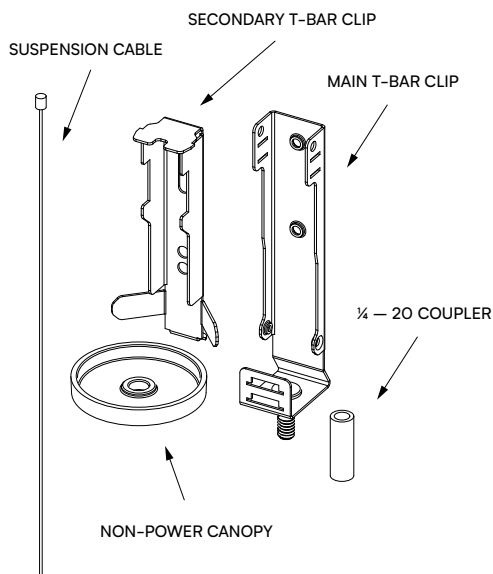

+ G1 – Power Mounting Kit 1-CCT

- 1 x Main T-Bar Clip
- 1 x Secondary T-Bar Clip
- 1 x Power Canopy
- 1 x ¼-20 Griplock Coupler
- 1 x A/C Suspension Cable
- 2 x #10-32 1/4"
- 1 X Power Feed Conduit

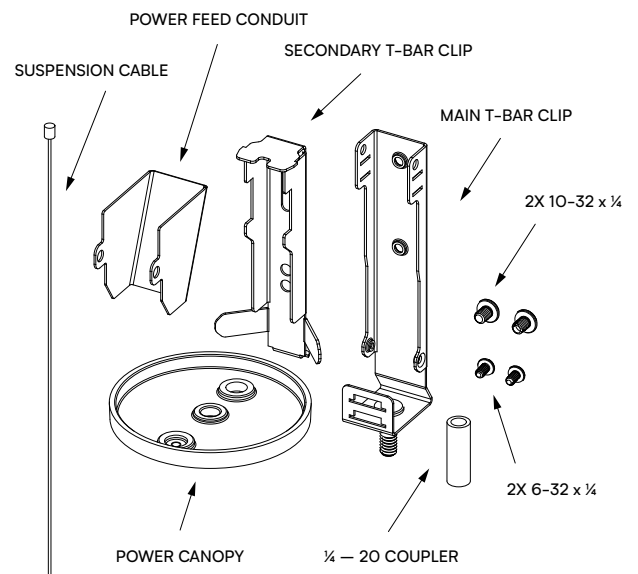

+ G1 – Power Mounting Kit 2-CCT

- 1 x Main T-Bar Clip
- 1 x Secondary T-Bar Clip
- 1 x Dual Power Canopy
- 1 x ¼-20 Griplock Coupler
- 1 x 6-32 Phillips Pan Head Screw
- 1 x A/C Suspension Cable

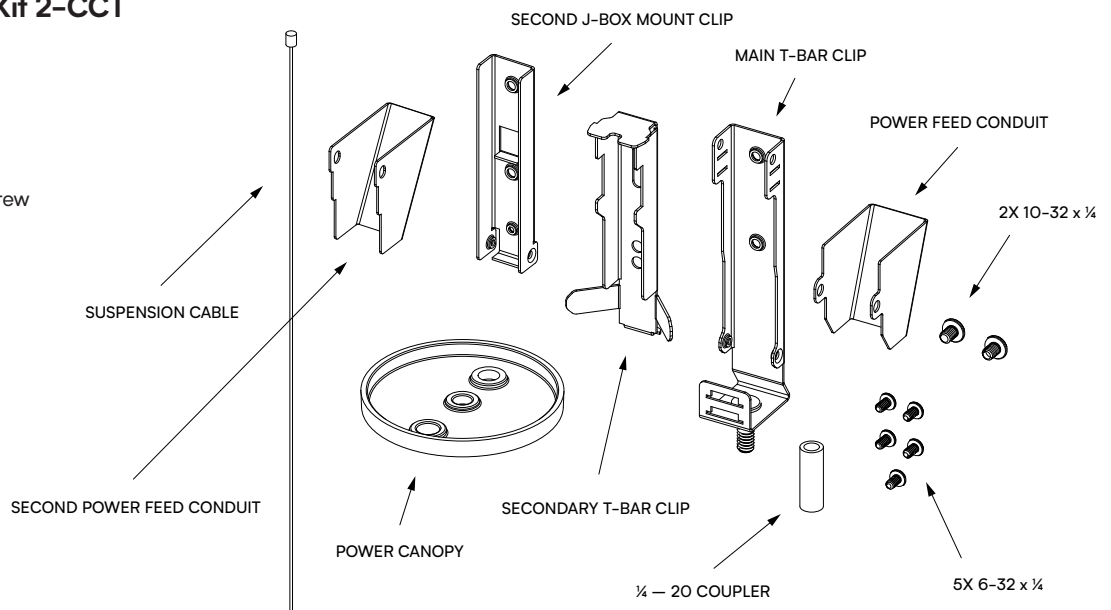

ACT Grid Ceilings (G1)

Information

+ Important

- Read all instructions including wiring and mechanical details before starting the installation.
- Install in accordance with the local and national building and electrical codes.
- Contact factory if you require assistance or have questions.
- CONSULT A QUALIFIED ELECTRICIAN TO ENSURE CORRECT BRANCH CIRCUIT CONDUCTOR. / CONSULTER UN ÉLECTRICIEN QUALIFIÉ POUR VOUS ASSURER QUE LES CONDUCTEURS DE LA DÉRIVATION SONT ADÉQUATS.

+ Notes

- **ACCESS ABOVE CEILING REQUIRED**
"ACCÈS REQUIS AU-DESSUS DU PLAFOND"
- This instruction guide covers the installation of G1 mounting kits. Refer to the Instructions below for the necessary components and steps for a standard installation.
- Power mount canopies are compatible with 4" octagonal J-Boxes and 4x4 square J-Boxes.
- Dual power kits will come with two holes in the canopy for the power cords.



Tools Required

Tools:

- #2 Phillips Screw Driver
- Pliers

Materials:

- Hanger wire (by others)
- #8 Sheet Metal Screws
- J-Box (by others)



Safety Warnings

- **Shock hazard!** Fixtures must be connected to building ground via provided ground wire before connecting to main supply power.
- Disconnect or turn off power supply before attempting any installation maintenance or servicing operations.

+ Power Cords Come Installed on Fixtures

NOTE: 1 clip is to be placed on the power cord every 4" (102 mm).

NOTE: US power cords come with O-rings. For a 2-CCT application 2 x power cords are required. O-rings must be placed on the power cord prior to making electrical connections. The suspension cable can be fed through the O-ring during the suspension connection step.

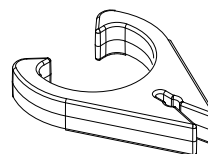

CORD CLIP

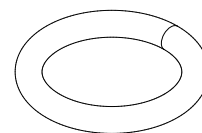

O-RING*

+ Ceiling Preparation

This instruction guide covers the installation of G1 universal mounting kits. Refer to the Instructions below for the necessary components for a standard installation.

The universal G1 mounting kit accommodates all grid ceiling types:

- Flat T Grid (5/8" or 15/16")
- Slot Grid (5/8")
- Tegal (5/8" or 15/16")

Clearance Notch + Hole Dimensions

Canopy	On-Grid	Off-Grid
Non-Power	Notch tile Ø 1-3/4" (Ø 44.5 mm) half circle shape	Cut a Ø 1-3/4" (Ø 44.5 mm) circle shape
Power Canopy	Notch tile Ø 2-3/4" (Ø 70 mm) half circle shape	Cut a Ø 2-3/4" (Ø 70 mm) circle shape

ACT Grid Ceilings (G1)

Installation Steps — On Grid Non-Power

1 Install Non-Power Mounting Kit

Identify and gather the non-power mounting kit. Locate assigned locations as per the layout drawings.

2 Install Clips Onto T-Bar

1. Remove acoustic tile. Install main T-Bar clip and secondary T-Bar clip onto T-grid.
2. Secure hanger wires to clip and to structure.
3. Secure to grid with sheet metal screw.
4. Ensure the main mounting clip is flush and tight to the flat face of the T-Bar during securing to structure and grid. $\frac{1}{8}$ " Flat T shown for reference, acoustic tiles not shown.

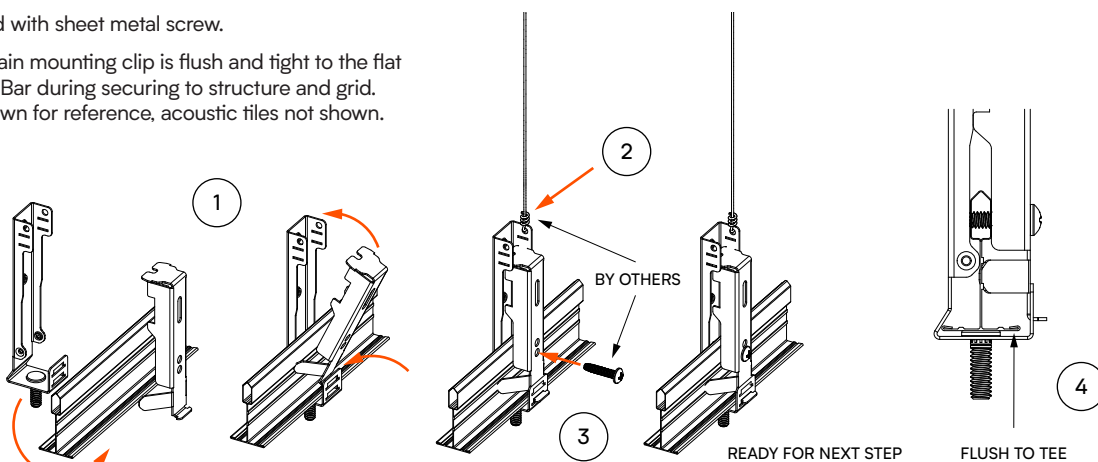

3 Install Suspension Cable, Coupler and Canopy

1. Feed suspension cable through the coupler.
2. Install the canopy so the $\frac{1}{4}$ -20 stud goes through the hole.
3. Secure canopy with coupler onto stud on T-Bar clip. Prepare acoustic tile (notch out tile as per clearance dimension table). Install acoustic tile.

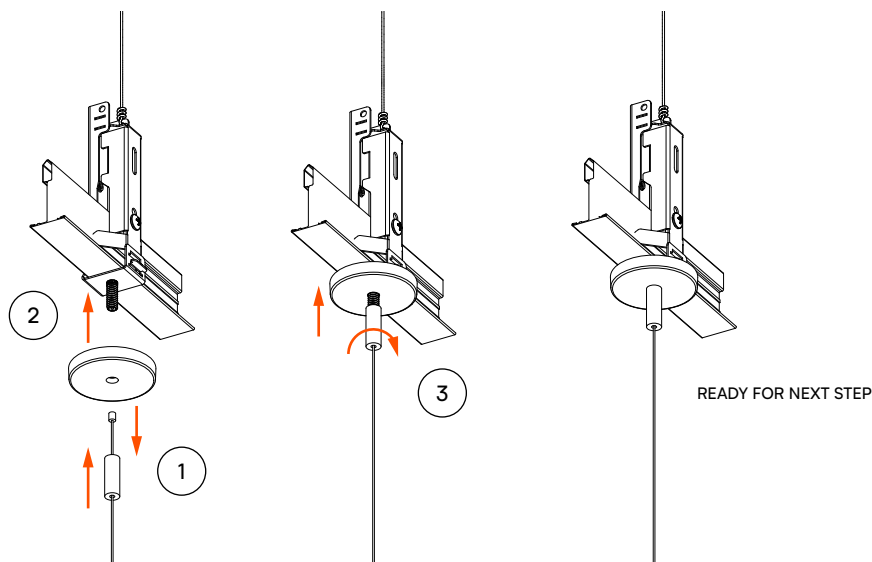

ACT Grid Ceilings (G1)

Installation Steps — On Grid 1-CCT Power

4 Install 1-CCT Power Mounting Hardware

Identify and gather the 1-CCT power mounting kit. Locate assigned locations as per the layout drawings.

5 Install Clips Onto T-Bar and Power Conduit Onto T-Bar Clip

Repeat Step 2 of non-power installation steps. Prepare and install acoustic ceiling tiles before installing the main power conduit to the main T-Bar clip with provided 6-32 screws. 1/8" Shown for reference, acoustic tiles not installed.

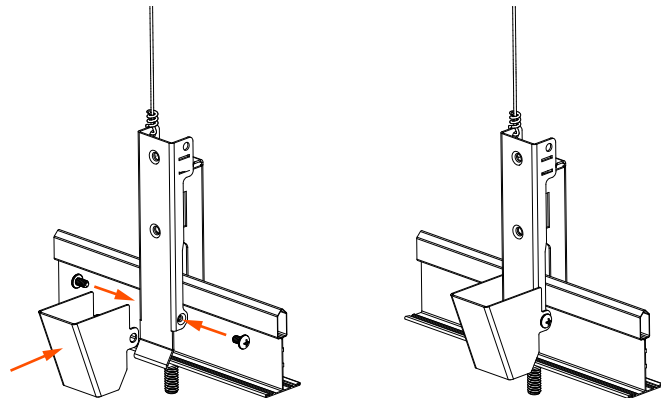

READY FOR NEXT STEP

6 Install Suspension Cable, Coupler and Canopy

1. Feed suspension cable through the coupler.
2. Install the canopy so the 1/4-20 stud goes through the hole.
3. Secure canopy with coupler onto stud on T-Bar clip. Prepare acoustic tile (notch out tile as per clearance dimension table). Install acoustic tile.

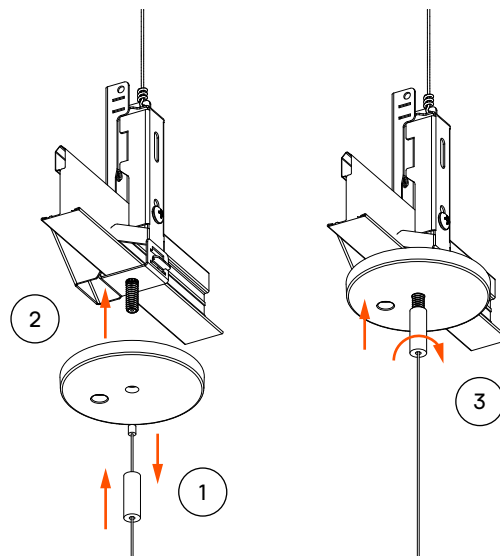

READY FOR NEXT STEP

ACT Grid Ceilings (G1)

7 Install J-Box

1. Remove appropriate EKO's from the J-Box for electrical connections.
2. Install J-Box (by others) onto the main T-Bar clip with provided 2 x 10-32 screws.

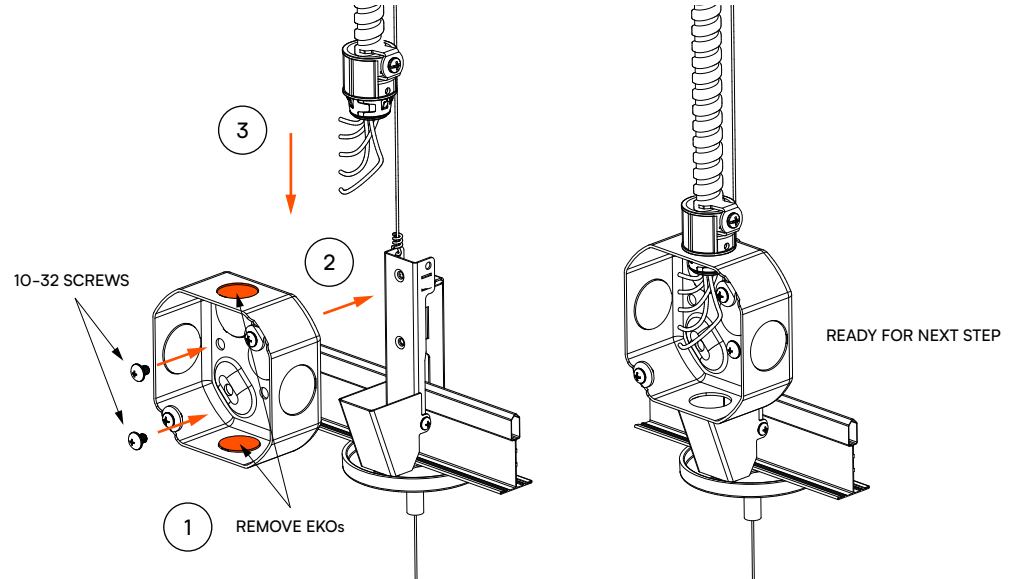

8 Make Electrical Connections

1. Install power cord through hole in power canopy.
2. Feed cord up into J-Box through the power conduit, tie cord into an overhand knot.
3. Connect ground wires first with provided 3 lever WAGO, then complete remaining electrical connections with provided 2 lever WAGOs.
4. Safely tuck wires into J-Box and secure cover. Prepare acoustic tile (notch out tile as per clearance dimension table) Install acoustic tile.

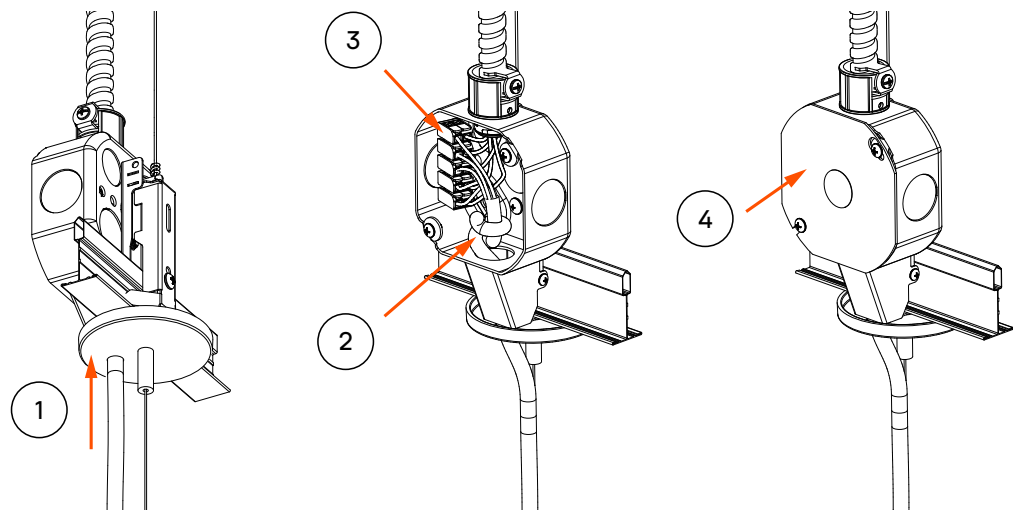

ACT Grid Ceilings (G1)

Installation Steps — On Grid 2-CCT Power

9 Install 2-CCT Power Mounting Hardware

Identify and gather the 2-CCT power mounting kit. Locate assigned locations as per the layout drawings.

10 Install Clips Onto T-Bar

1. Secure secondary J-Box mount clip to secondary T-Bar clip with supplied 6-32 screw.
2. Install main T-Bar clip and secondary T-Bar clip with secondary J-Box mount clip onto T-grid.
3. Secure hanger wires to clip and to structure. Ensure the main mounting clip is flush and tight to the flat face of the T-Bar during securing to structure 15/16 Flat T shown for reference.

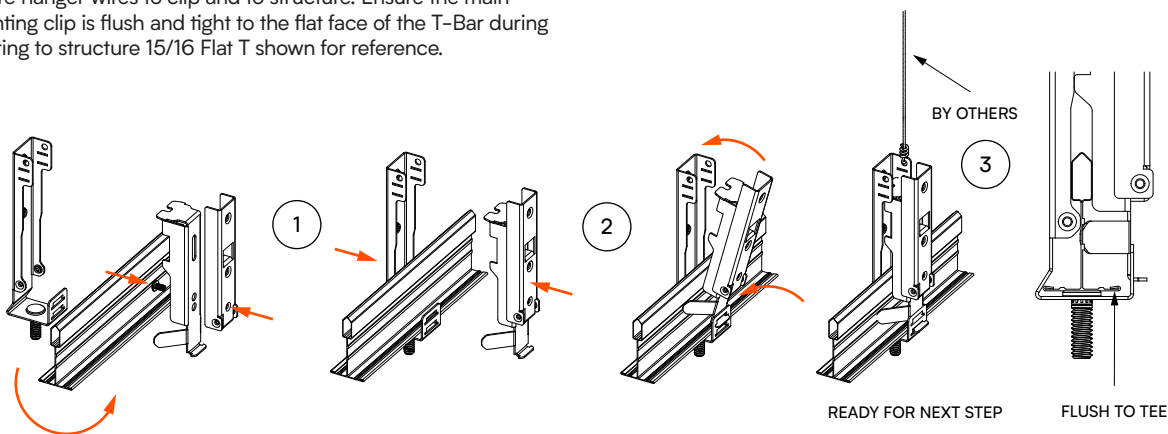

11 Install Power Conduits Onto T-Bar Clips

Repeat Step 2 of On Grid 1-CCT Power to install the main power conduit. Install the 2nd power conduit to the 2nd J-Box mount clip with provided 6-32 screws. 1/4" Shown for reference.

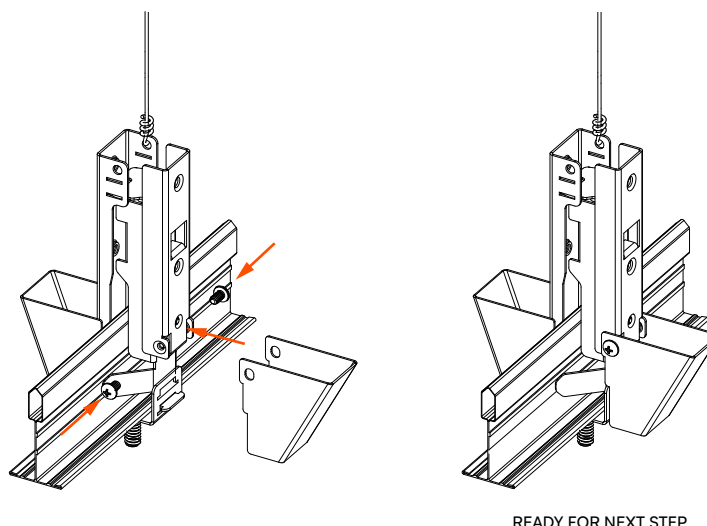

ACT Grid Ceilings (G1)

12 Install J-Box

1. Repeat Steps 4 + 5 from 1-CCT Power Steps to install the main electrical connection.
2. Connect the second J-Box (by others) to the secondary mount clip with the provided 2 x 10-32 screws.
3. Remove appropriate EKO's for electrical connection steps.

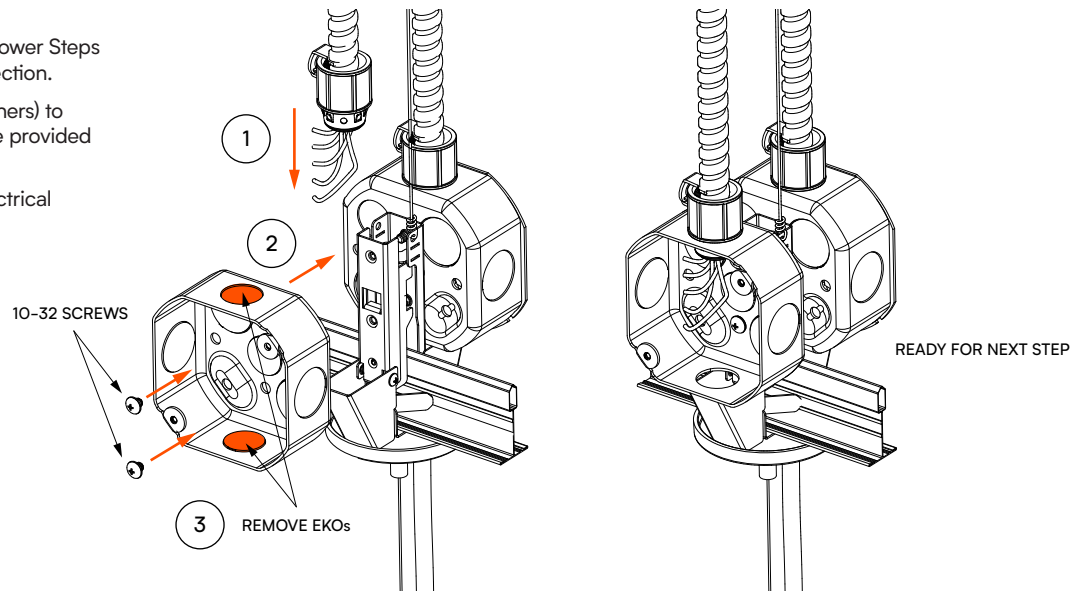

13 Make Electrical Connections

1. Install power cord through second hole in power canopy.
2. Feed cord up into J-Box through the power conduit, tie cord into an overhand knot.
3. Connect ground wires first with provided 3 lever WAGO, then complete remaining electrical connections with provided 2 lever WAGOs.
4. Safely tuck wires into J-Box and secure cover. Prepare acoustic tile (notch out tile as per clearance dimension table) Install acoustic tile.

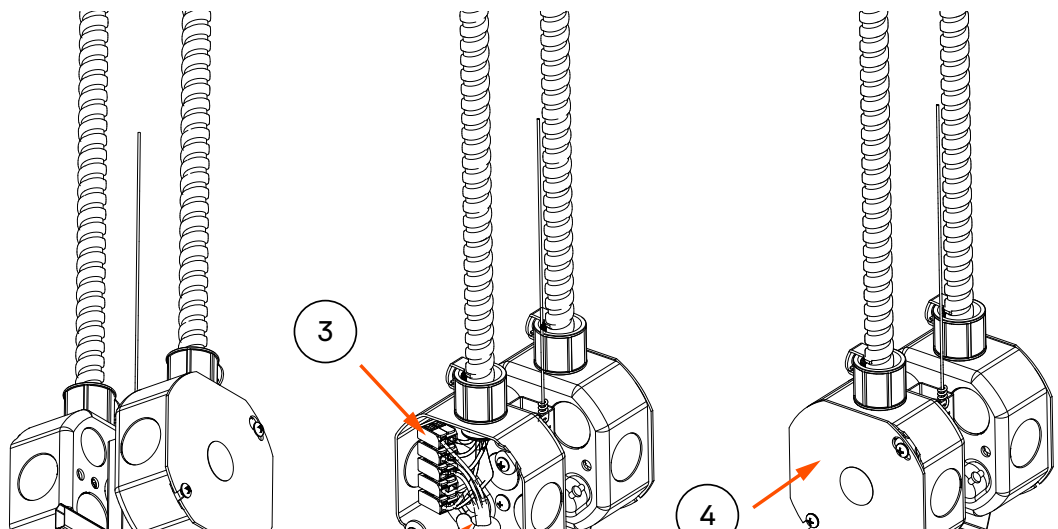

ACT Grid Ceilings (G1)

Installation Steps — Off Grid Non-Power

1 Install Non-Power Mounting Hardware

Identify and gather the non-power mounting hardware. Locate assigned locations as per the layout drawings. Prepare acoustic tile (notch out tile as per clearance dimension table). Install acoustic tile. Remove adjacent tiles to allow for access from above to complete installation steps.

2 Install Clips Onto T-Bar

1. Install main T-Bar clip and secondary T-Bar clip onto Caddy clip.
2. Secure hanger wires to clip and to structure.
3. Secure to Caddy bar with sheet metal screw. Ensure to secure brackets to tile so the canopy is flush to tile when installed.

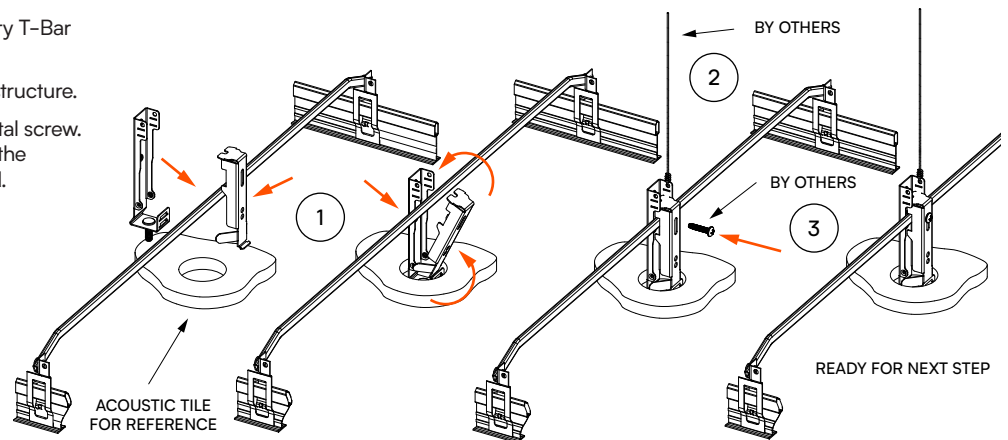

3 Install Suspension Cable, Coupler and Canopy

1. Feed suspension cable through the coupler.
2. Install the canopy so the 1/4-20 stud goes through the hole.
3. Secure canopy with coupler onto stud on T-Bar clip.

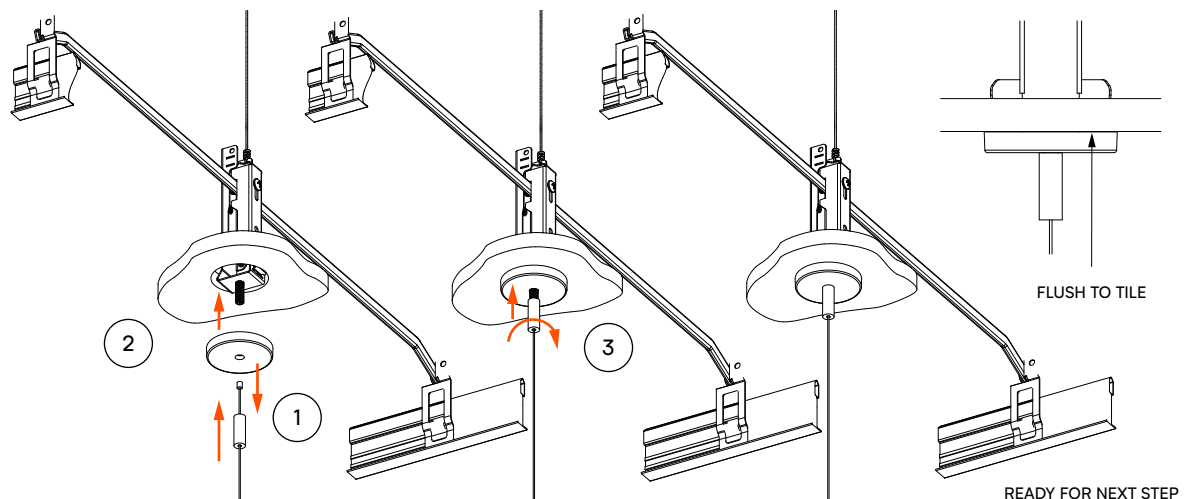

ACT Grid Ceilings (G1)

Installation Steps — Off Grid 1-CCT Power

4 Install 1-CCT Power Mounting Hardware

Identify and gather the 1-CCT power mounting kit. Locate assigned locations as per the layout drawings.

5 Install Clips Onto T-Bar + Install Power Feed Conduit

1. Repeat Step 2 for off grid non-power.
2. Install the power feed conduit main T-Bar clip with provided 6-32 screws. 15/16 Shown for reference. Partial acoustic tile shown for reference.

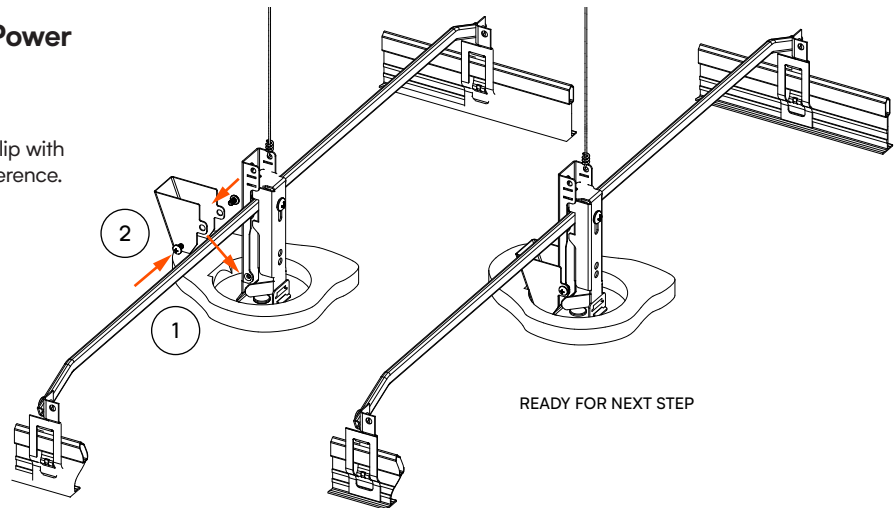

6 Install Suspension Cable, Coupler and Canopy

1. Feed suspension cable through the coupler.
2. Install the canopy so the 1/4-20 stud goes through the hole.
3. Secure canopy with coupler onto stud on T-Bar clip.

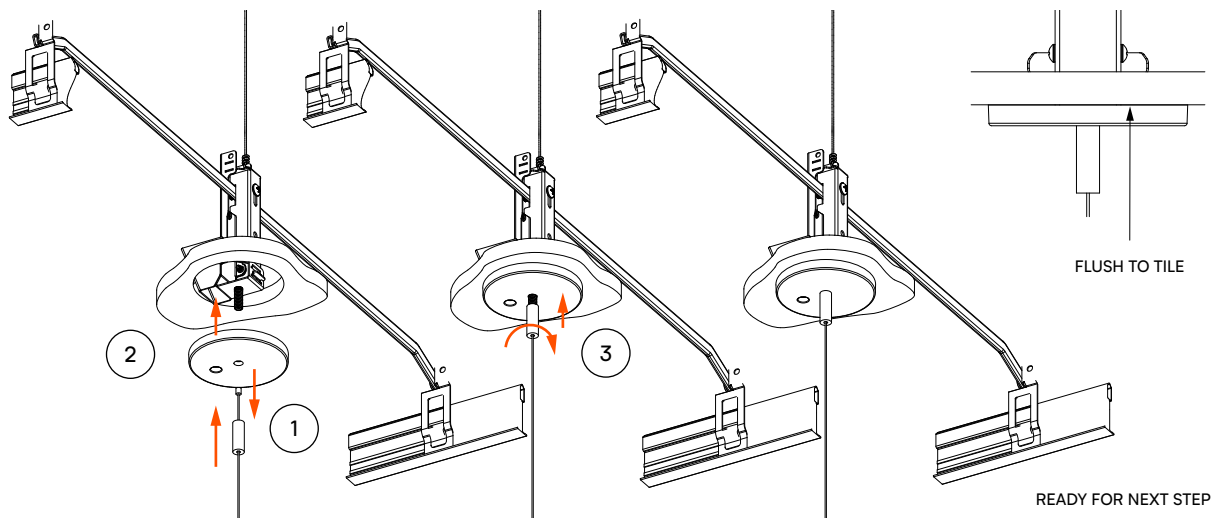

ACT Grid Ceilings (G1)

7 Install J-Box

1. Remove appropriate EKO's for electrical connection steps.
2. Install J-Box (by others) onto the main T-Bar clip with provided 2 x 10-32 screws.
3. Install power supply to J-Box.

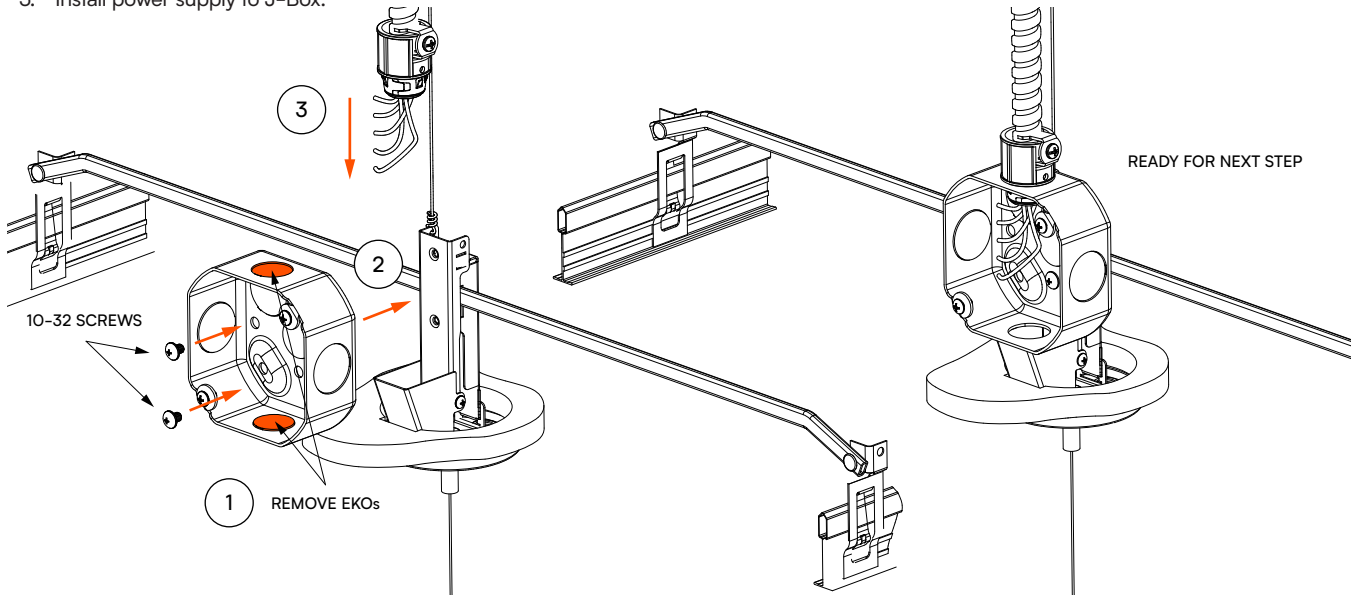

8 Make Electrical Connections

1. Install power cord through second hole in power canopy.
2. Feed cord up into J-Box through the power conduit, tie cord into an overhand knot.
3. Connect ground wires first with provided 3 lever WAGO, then complete remaining electrical connections with provided 2 lever WAGOs.
4. Safely tuck wires into J-Box and secure cover.

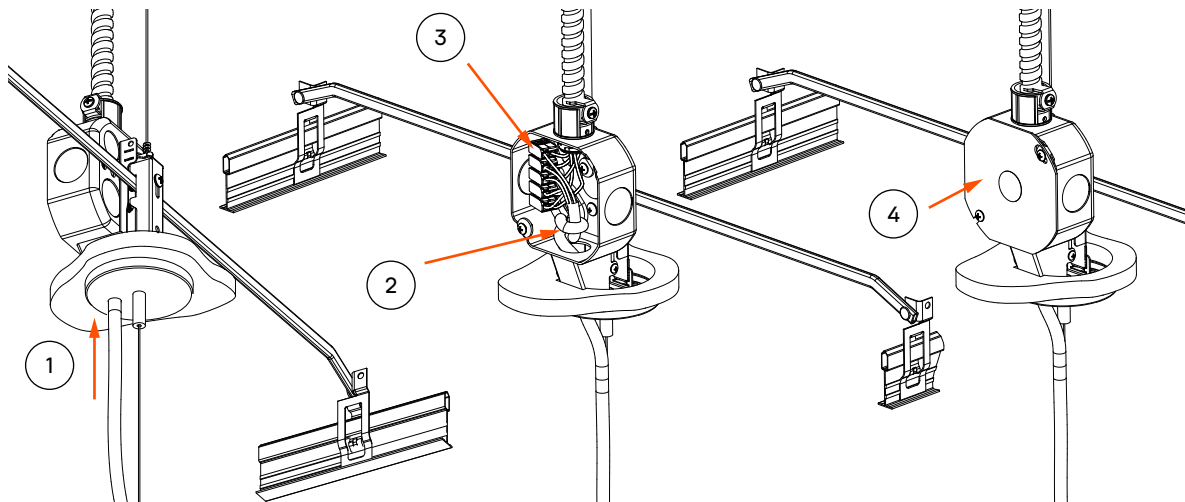

ACT Grid Ceilings (G1)

Installation Steps — Off Grid 2-CCT Power

9 Install 2-CCT Power Mounting Hardware

Identify and gather the 2-CCT power mounting kit. Locate assigned locations as per the layout drawings. Prepare acoustic tile (notch out tile as per clearance dimension table, modify as required to fit) Install acoustic tile. Remove adjacent tiles to allow for access from above to complete installation steps.

10 Install Clips Onto T-Bar

1. Secure secondary J-Box mount clip to secondary T-Bar clip with supplied 6-32 screw.
2. Install main T-Bar clip and secondary T-Bar clip with secondary J-Box mount clip onto Caddy clip. Caddy 512 shown for reference.
3. Secure with guy wire tie off to structure
4. Secure with sheet metal screw.

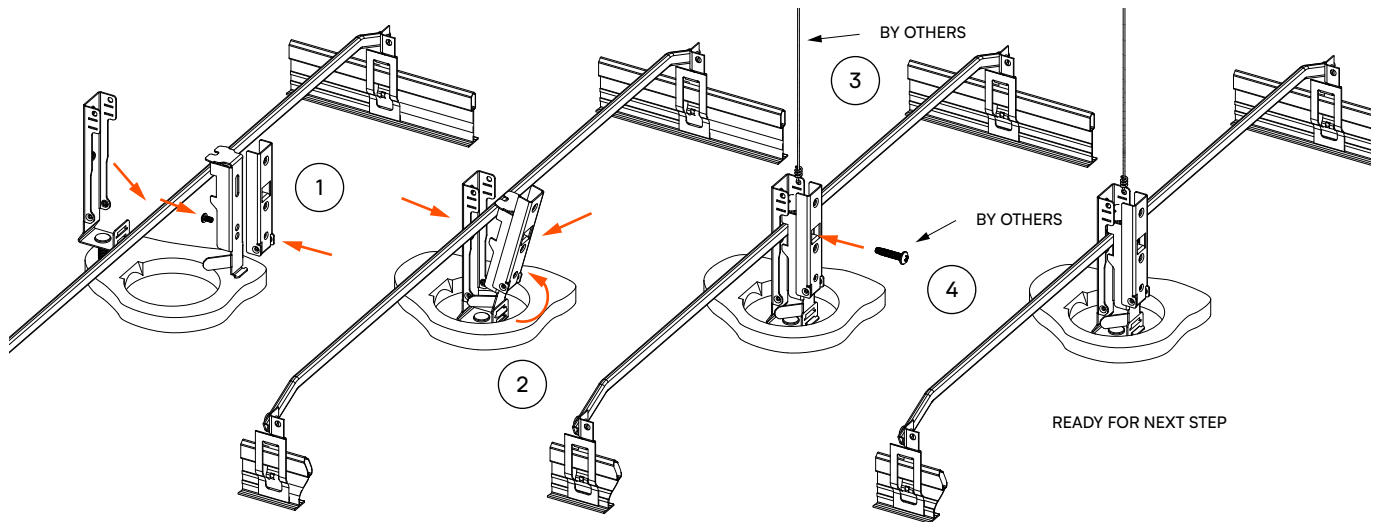

ACT Grid Ceilings (G1)

11 Install Power Feed Conduits

1. Repeat Step 5 and proceed to install 2nd power feed conduits with provided 6-32 screws.
2. Note you may need to modify the notch to fit the second power feed conduit.

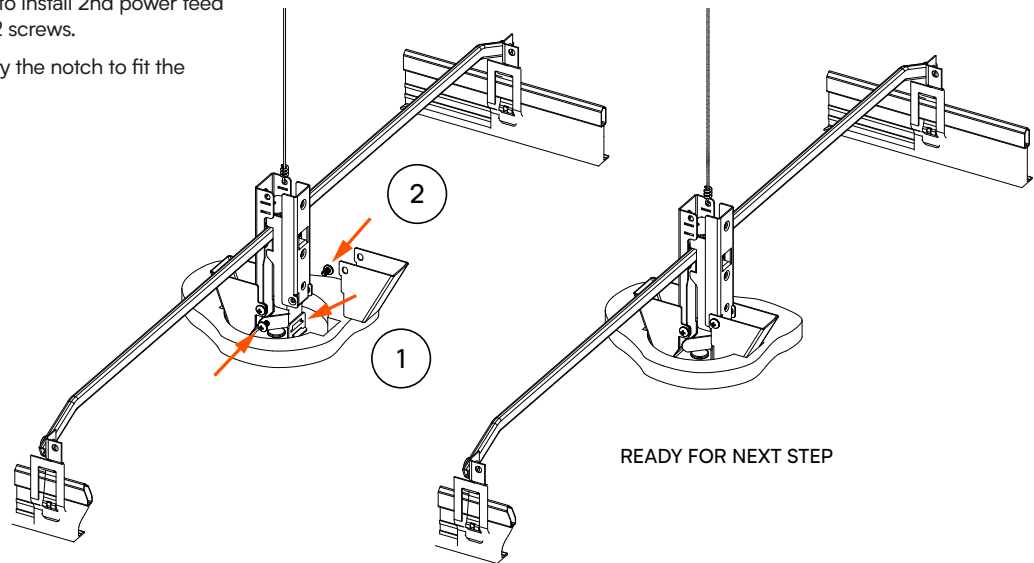

12 Install J-Box

1. Repeat Steps 6 to 8 to connect the first power connection.
2. Connect the second J-Box (by others) to the secondary mount clip with the provided 2 x 10-32 screws.
3. Remove appropriate EKO's for power connection steps.

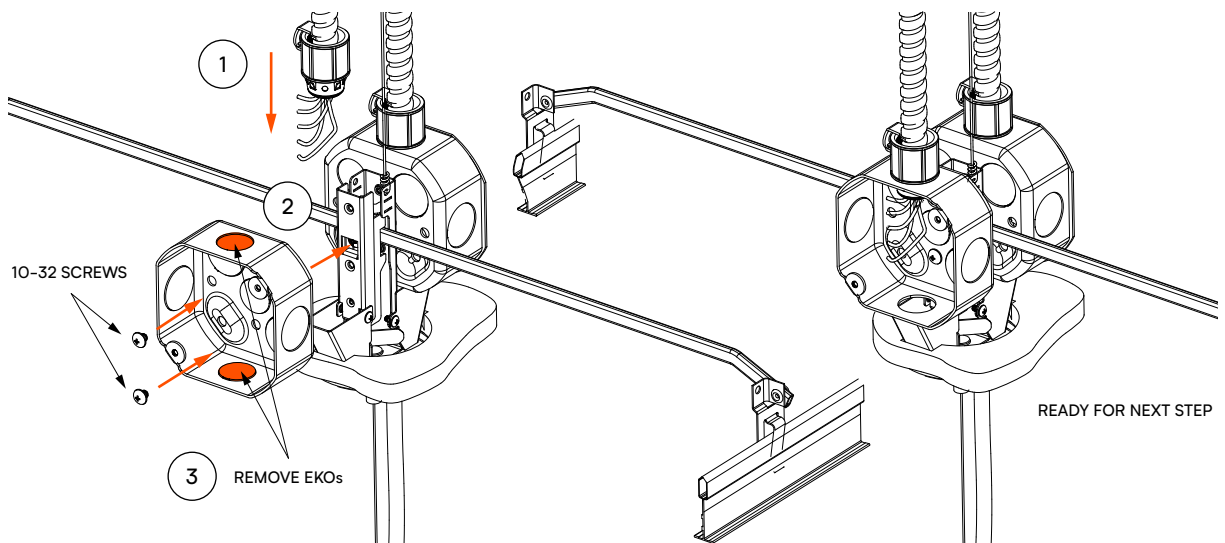

ACT Grid Ceilings (G1)

13 Make Electrical Connections

1. Install power cord through second hole in power canopy.
2. Feed cord up into J-Box through the power conduit, tie cord into an overhand knot.
3. Connect ground wires first with provided 3 lever WAGO, then complete remaining electrical connections with provided 2 lever WAGOs.
4. Safely tuck wires into J-Box and secure cover.

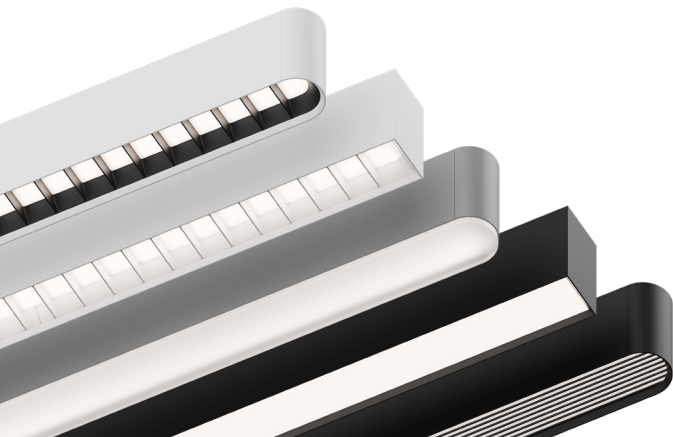
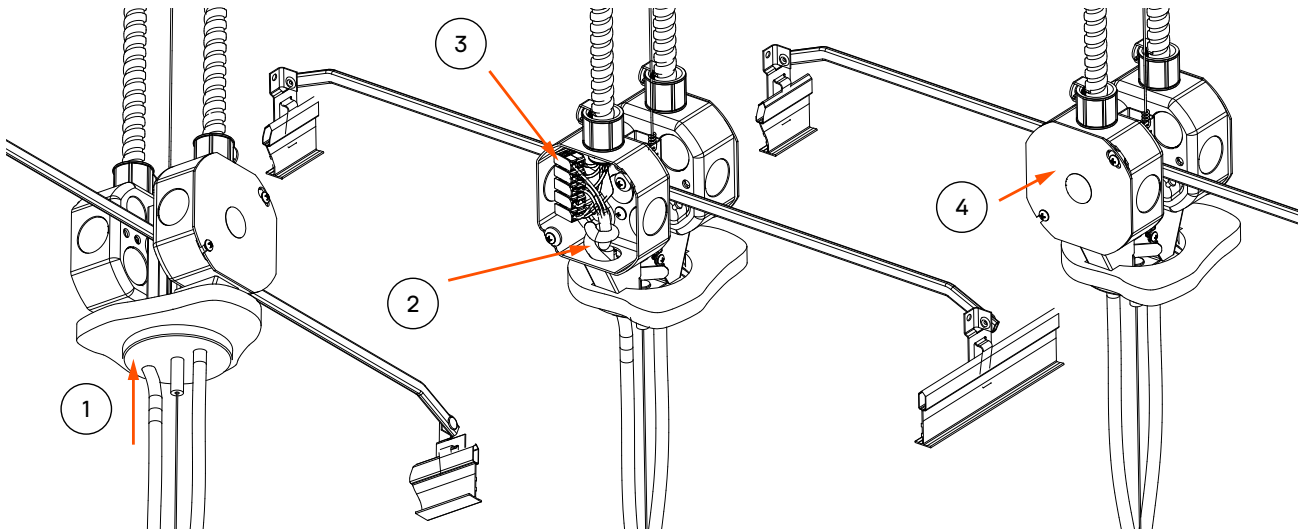

Different thinking, by design.



**real help.
real people.
real answers.**

778.650.1000
justask@mindsetlighting.com